

PCB LAYOUT  
S=2:1

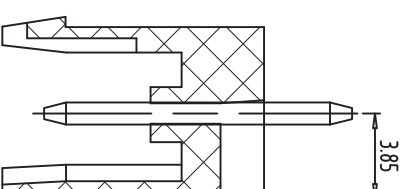

SECTION:A-A

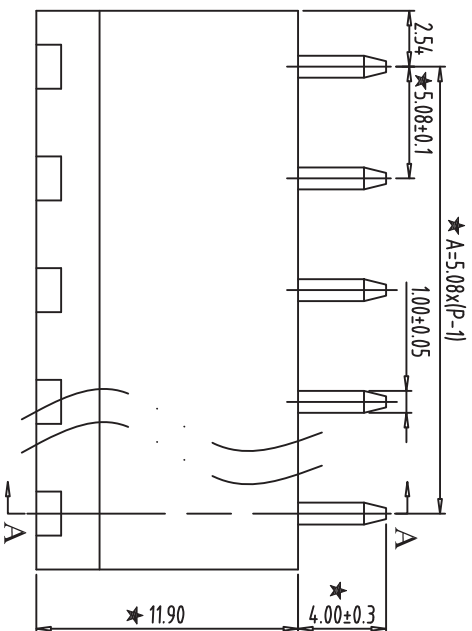
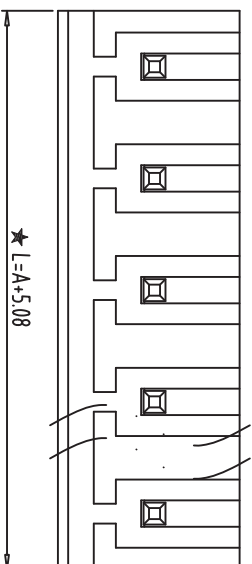
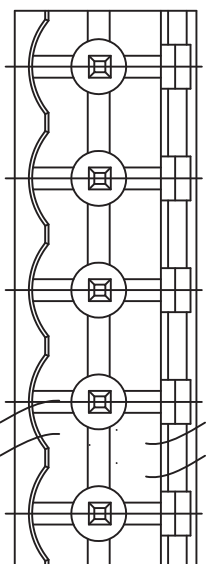
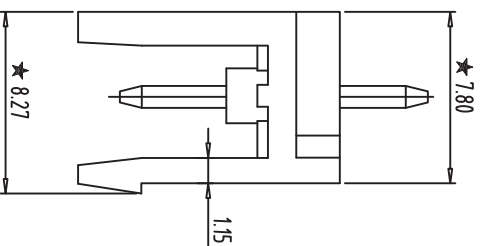

- NOTES:
1. Rating:300V 15A ;
  2. Insulation Withstands Voltage: AC2000V/MIN
  3. Insulation Resistance: 500M $\Omega$  or more at DC500V
  4. Using Temperature Range: -40°C~+105°C
  5. "★" is the important dimension
  6. RoHS compliance

Total Pitch Tolerances		Nominal dimension range																											
In mm		In mm																											
0	to	0	to	30	to	53	to	70	to	90	to	115	to	150	to	200	to	250	to	320	to	100	to	150	to	100	to	150	
±0.18	±0.20	±0.25	±0.3	±0.35	±0.44	±0.60	±0.70	±0.85	±0.20	±0.25	±0.30	±0.35	±0.44	±0.55	±0.70	±0.80	±0.90	0.2	0.3	0.3	0.2	0.3	0.3	0.2	0.3	0.3	0.2	0.3	0.5

ITEM	NAME OF PART	NO. OF PART	Q'TY	MATERIAL	NOTE
DWG	SK	DATE	2014/08/19	SIZE	A4
CHK		DATE		SCALE	3:1
APP.		DATE		SCALE	2EDG-5.08
深圳市金航标电子有限公司				WWW. BDS666. COM	
KH-F400V-4P-5. 08G				0755-83044319	