

Kinghelm®

| REV |  | NUMBER | DESCRIPTION | DWN | CHK | DATE |
|-----|--|--------|-------------|-----|-----|------|
| A   |  |        | DESIGN      |     |     |      |

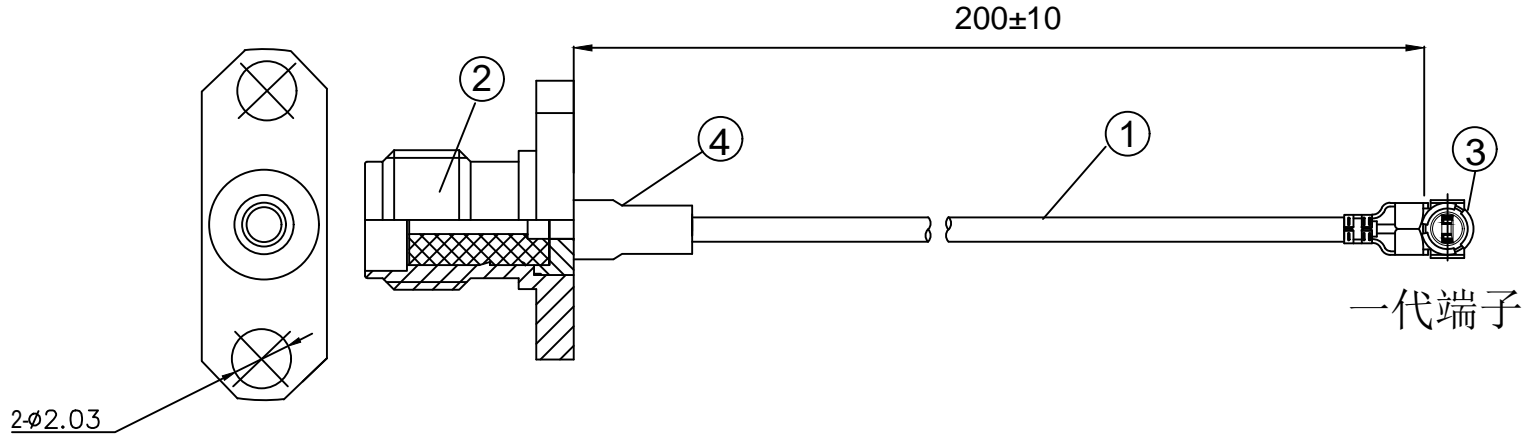

NOTES:

1. ELECTRICAL:
  - 1.1. VOLTAGE RATING:DCV 300V 10MS
  - 1.2. CONDUCTANCE RESISTANCE: 3.0 OHM/MAX.
  - 1.3. INSULATION RESISTANCE: 5.0M OHM/MIN.
  - 1.4. THE CABLE SHOULD BE 100% ELECTRICAL TEST
  - 1.5. IT SHOULD BE NO ANY OPEN/SHORT, MISWIRING AND INTERMITTENT FAILURES.
2. MATERIAL:
  - 2.1. SEE TABLE
3. ALL COMPONENTS ARE RoHS COMPLIANT.

| ITEM NO. | PART NUMBER | DESCRIPTION                  | QTY. |
|----------|-------------|------------------------------|------|
| ④        | 套管          | 黑色热缩套管, OD:2.5MM             | AS   |
| ③        | 端子          | 高仿I-PEX ,一代端子, 镀金            | 1    |
| ②        | 接头          | SMA母头母针, 2孔法兰, 镀金, 外螺纹内孔     | 1    |
| ①        | 同轴线         | RF178cable, 棕色同轴线, OD:1.78mm | AS   |

深圳市金航标电子有限公司  
SHENZHEN KINGHELM ELECTRON CO., LTD.

www.kinghelm.com.cn  
0755-28190160

|                                  |  |                    |                           |
|----------------------------------|--|--------------------|---------------------------|
| ALL DIMENSION ARE IN MM          | DRAWN<br>Jamy  | DATE<br>2023-08-18 | KH-FL2SMAK-IPEX-RG178-200 |
|                                  | ENG.   |                    |                           |
| COMPUTER GENERATED IN SOLIDWORKS | MFG.   |                    |                           |
| DO NOT SCALE THIS DRAWING        | Q.A.   |                    |                           |
| PROJECTION                       | GENERAL TOLERANCE FOR ANGLES X.X X.XX X.XXX<br>± 1° ± 0.3 ± 0.25 ± 0.150 |                    | SIZE<br>B                 |
| CUSTOMER P/N:                    |  |                    | REV<br>A                  |
|                                  | SCALE: Free  | TYPE               | SHEET 1 OF 1              |