

**Kinghelm®**

∅0.90吸嘴位置

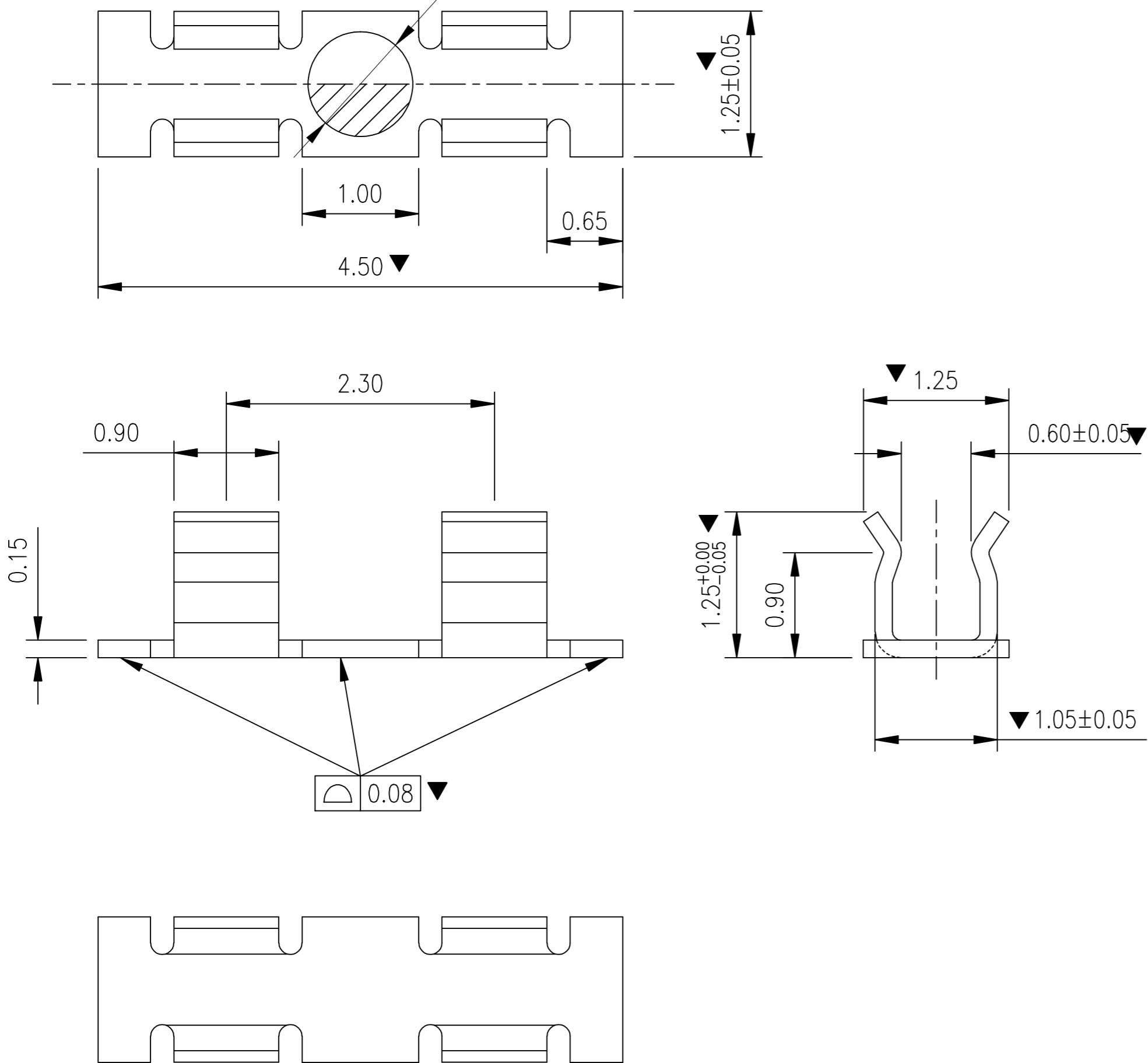

Rev.	ECN Number	Description	Date	Drawn	Checkd	Approved

技术要求:

1. 材质: 不锈钢SUS301, T=0.15±0.005;
2. 端子锡脚焊接面和接触面不可有毛边, 其他部位毛边最大0.03mm;
3. 扭曲: 45°/1000mm, 拱形 5mm/1000mm;
4. 标示有“▼”符号的为重点控制和检验尺寸;
5. 未标注之R MAX R0.13;
6. 电镀须满足24小时盐雾测试;
7. 寿命测试>2万次, 产品弹力要求在60gf~80gf之间
8. 镍底50~80u"min, 产品外表面镀锡80~100U"MIN

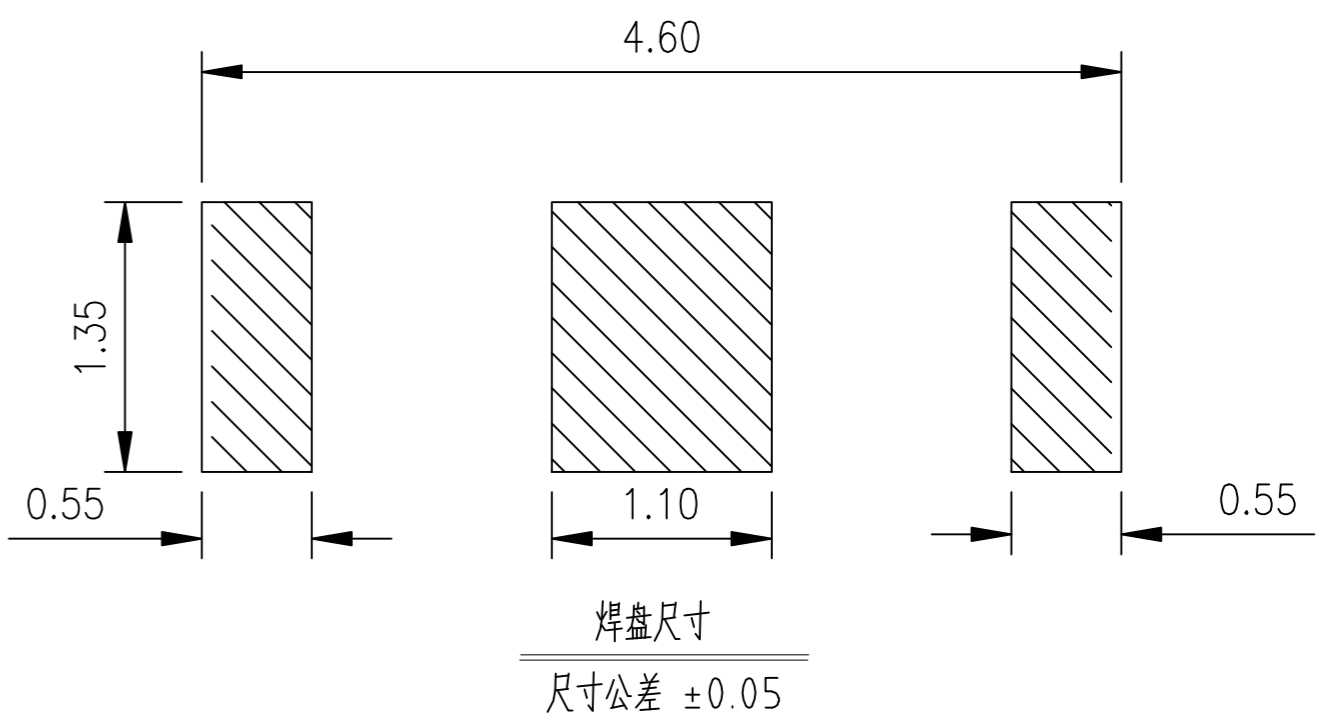

TITLE <b>客户图</b> RF CABLE(∅0.81) CAN CLIP L4.5*W1.25*H1.25	GENERAL TOLERANCE		SCALE: 1:1	DRAWN	DATE	DWG. NO.	深圳市金航标电子有限公司	www.kinghelm.com.cn	REV.
	XX. ±0.50	X.° ±2.0°	UNIT: mm	CHECK	DATE	681-0074A-01			A
	.X ±0.35		.X° ±1.0°	SIZE: A4	APPROVE	DATE	PARTS NO.(INTENDED USE)	SHEET	
	.XX ±0.15	.XX° ±0.5°				0074A1	KH-PBJ-45125125	0755-28190160	1/2